

PRODUCT INFORMATION PACKET

marathon[®]
Motors

Model No: 215TBDW7362
Catalog No: Z126
10,1800,DP,215TZ,1/60/230
Single Phase



Regal and Marathon are trademarks of Regal Beloit Corporation or one of its affiliated companies.
©2018 Regal Beloit Corporation, All Rights Reserved. MC017097E

REGAL[®]



Nameplate Specifications

Output HP	10 Hp	Output KW	7.5 kW
Frequency	60 Hz	Voltage	230 V
Current	44.0 A	Speed	1730 rpm
Service Factor	1.15	Phase	1
Efficiency	8 %	Duty	Continuous
Insulation Class	F	Design Code	L
KVA Code	G	Frame	215TZ
Enclosure	Drip Proof	Overload Protector	No
Ambient Temperature	40 °C	Drive End Bearing Size	6307
Opp Drive End Bearing Size	6206	UL	Recognized
CSA	Y	CE	Y
IP Code	22		

Technical Specifications

Electrical Type	Capacitor Start Capacitor Run	Starting Method	Across The Line
Poles	4	Rotation	Selective Counterclockwise
Mounting	Rigid base	Motor Orientation	Horizontal
Drive End Bearing	Ball	Opp Drive End Bearing	Ball
Frame Material	Rolled Steel	Shaft Type	Single Special Extension
Overall Length	18.7 in	Frame Length	12.40 in
Shaft Diameter	1.125 in	Shaft Extension	2.88 in
Assembly/Box Mounting	F1 Only		
Outline Drawing	A-SS88464-1240	Connection Diagram	A-EE9048LP

SS88464

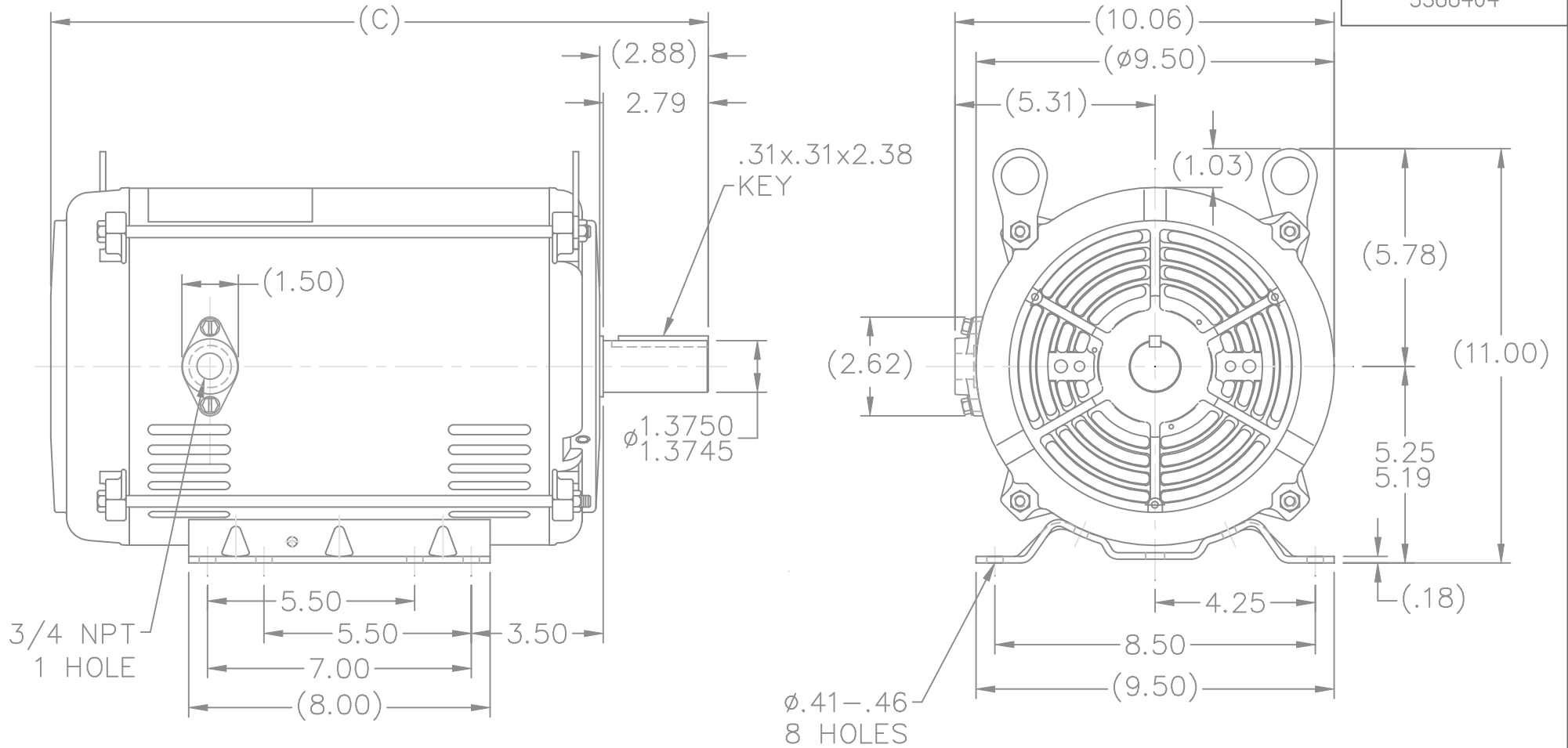

DASH	FR.	C	BS
965	213T	15.95	5.43
1115	213/15T	17.45	6.93
1240	213/15T	18.70	8.18

NOTES:

1. NAMEPLATE TO BE READ FROM LEAD EXIT SIDE OF MOTOR.
2. SEE MODEL FOR LEAD LENGTH.

				TOLERANCES UNLESS SPECIFIED			DRAWN CAV 6/8/2001			
NO.	REVISION	BY & DATE	CHK	ANG	±		SCALE	REF	PREV	
5	REPLACED ADAPTER PLATE W/LEESON PLATE 07-1734	MSG 11-06-2008	MSG	DEC.	INCHES	MARATHON ELECTRIC TITLE OUTLINE 210T FR. - BB - SS - DR.PR. - 1Ø MAT'L. FINISH	CHK	CAV 6/8/2001		
4	UPDATED DRAWING	TJW 05/04/2007		.X	±.1		APPD	DR 6/12/2001		
3	3/4 NPT HOLE WAS 1 NPT HOLE CN35062	DRS 5/1/2002	ML	.XX	±.03	SCALE	1=4			
2	REMOVED MOUNTING AND NOTE 3	DRS 10/9/2001		.XXX	±.005	REF				
1	NEW DRAWING MU37695	CAV 6/12/2001		.XXXX	±.0005	FMF				
					±7'30"	PREV				
THIS DRAWING IN DESIGN AND DETAIL IS OUR PROPERTY AND MUST NOT BE USED EXCEPT IN CONNECTION WITH OUR WORK ALL RIGHTS OF DESIGN AND INVENTION ARE RESERVED THIS IS AN ELECTRONICALLY GENERATED DOCUMENT - DO NOT SCALE THIS PRINT				RFP		CAD FILE	ss88464	SIZE	DRAWING NO. PAGE 1 OF 1	REV.
				DIST	LB			A	SS88464	5

C.W. ROTATION

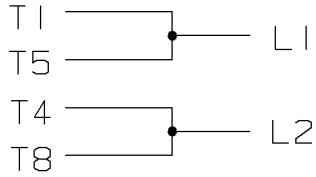

C.C.W. ROTATION

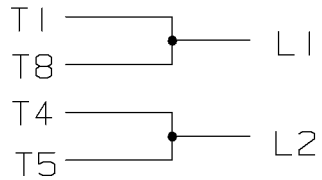

CONNECT:
START CAPACITORS IN SERIES
RUN CAPACITORS IN PARALLEL

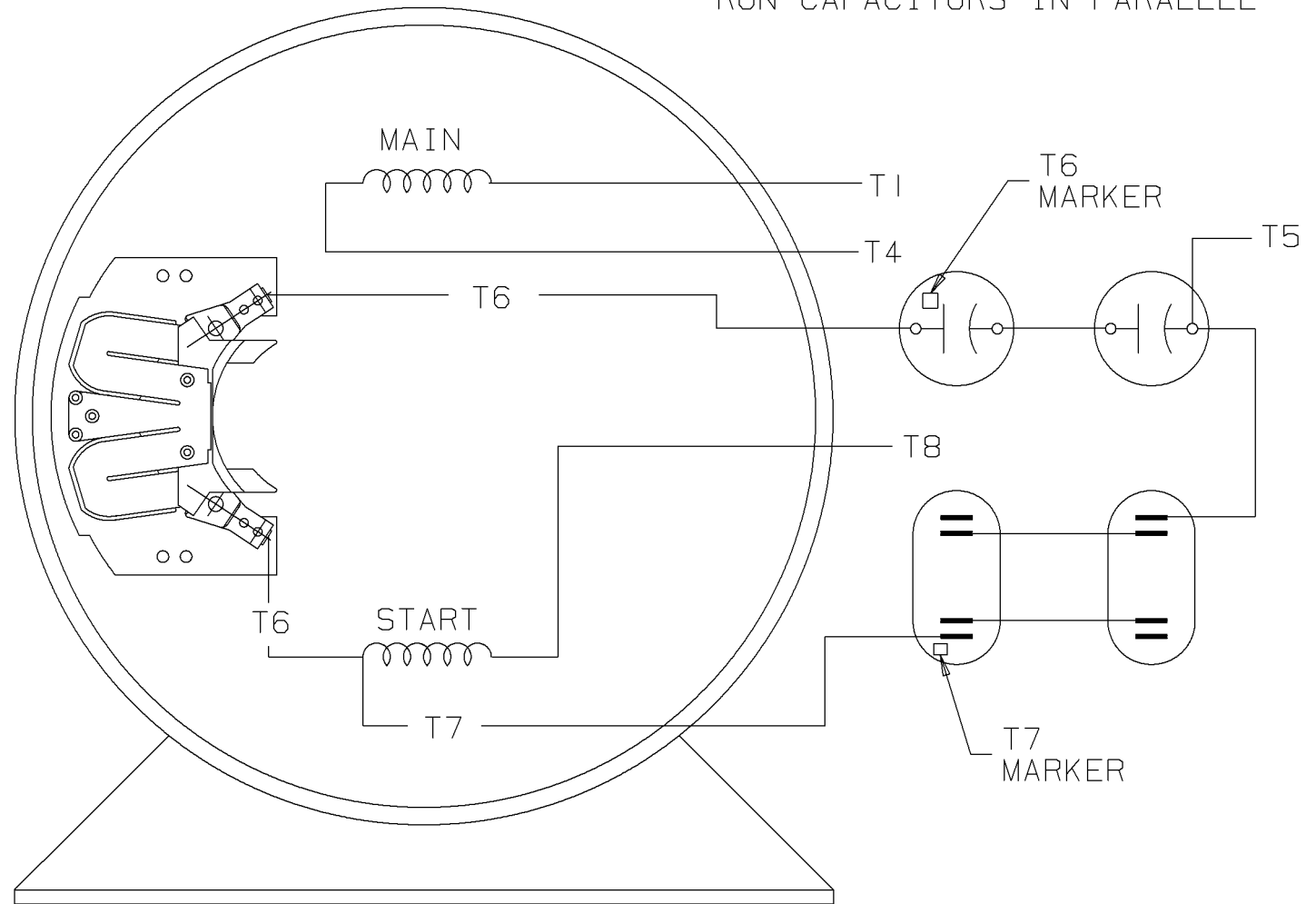

SINGLE VOLTAGE
CAPACITOR START
CAPACITOR RUN
REVERSIBLE

VIEW OF TERMINAL END

				✓ MAX. SURFACE ROUGHNESS UNLESS NOTED OTHERWISE	UNLESS OTHERWISE SPECIFIED DIMENSIONS ARE IN INCHES TOL. ON XX± XXX±.005 XXXX±.0005 ANGLES±		
				MATL SPEC	180 - 210 SWITCH		DRAWN BY GK 11-01-1986
				FINISH			CHKD BY FG 11-01-1986
1	11-04-1986	NEW DRAWING	CN 7664C	GK	REFERENCE DRW.	WAUSAU, WISCONSIN 54401	APPD BY ML 11-01-1986
REV	DATE	CHANGE		NAME	PART NAME CONNECTION DIAGRAM		DRWG NO A-EE9048LP

SHOP BOOK

PURCHASED

DISTRIBUTION - WA - LB - WP - LM - BR

CADD FILE NO.

EE9048LP

